

Office to let

Floreasca Business Center

Bucharest, Sector 2, 133-137 Floreasca Street

Building information

Building status	Existing
Year of construction	2000
Parking ratio	To be agreed
Total building area	5 994 sq m

Commercial terms

Office space*	after login *
Parking	after login *
Service charge*	after login *
Minimum lease term	after login *
Availability	after login *

* Asking terms for m²/month

Location



Available space

Building completely leased

Typical floor plan

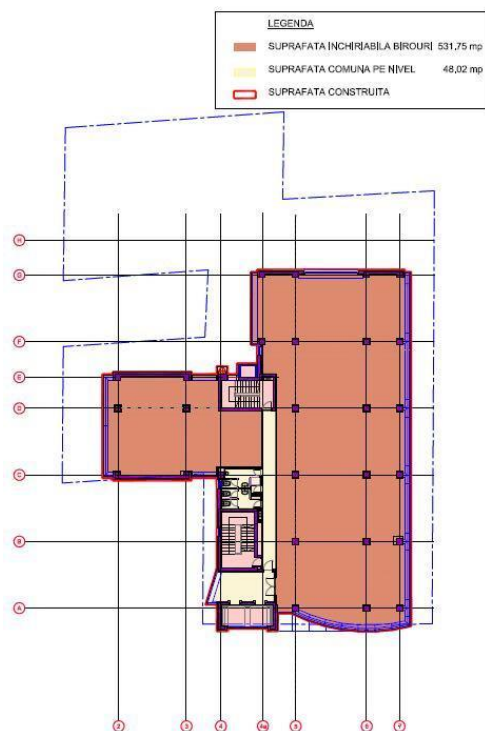

Public transport

Bus: 182, 282, 135

Contact



+40 21 302 3400

More information